

About Ariosh

Ariosh was incorporated in 1997 with a vision of becoming an EPCI (Engineering, Procurement, Construction and Installation) partner of choice in the West African oil & gas industry. The company has been a pioneer in the use of laser scanning in Nigeria since 2005 and has successfully completed many brownfield projects. We delivered our first construction management project in 2008 and first EPCI project in 2013. Ariosh's business remains mostly in brownfield and revamp projects, which contribute 70% of the company's revenue. The company has grown to over 250 employees with main customer base located in West Africa.

EGP 3B Project

Chevron Nigeria Limited (CNL)

Ariosh as a Nigerian leading EPCI contractor has secured a valuable competitive advantage by our **SureFIT™** work process which helped us to deliver several brownfield projects with the accuracy needed to achieve right-first-time installation. One of our recent success was Follow-on engineering and Construction Management of Chevron's Escravos Gas Project Phase 3B, after Chevron had been forced to halt installation work due to unforeseen design clashes.

Project Overview

In 2012 Ariosh was awarded the contract to provide follow-on engineering and construction management services on EGP3B, a gas gathering project that involve modification of seven (7) offshore production platforms. The topside modification includes installation of 6 large diameter pig launchers & receivers and large access platforms & deck extensions on heavily congested offshore production platforms.

Challenges

The challenges of executing brownfield projects became apparent following the completion of detailed engineering and fabrication drawings by an international EPC.

CNL experienced significant clashes during installation of the topside modifications on the first two of seven platforms. Worried that history would repeat itself with the remaining five platforms, the project was put on hold.

Ariosh was contracted to help recover the situation.

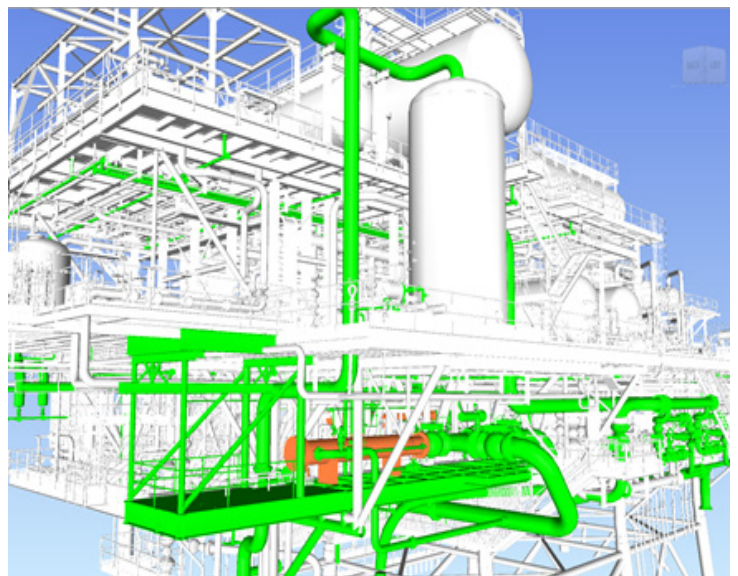

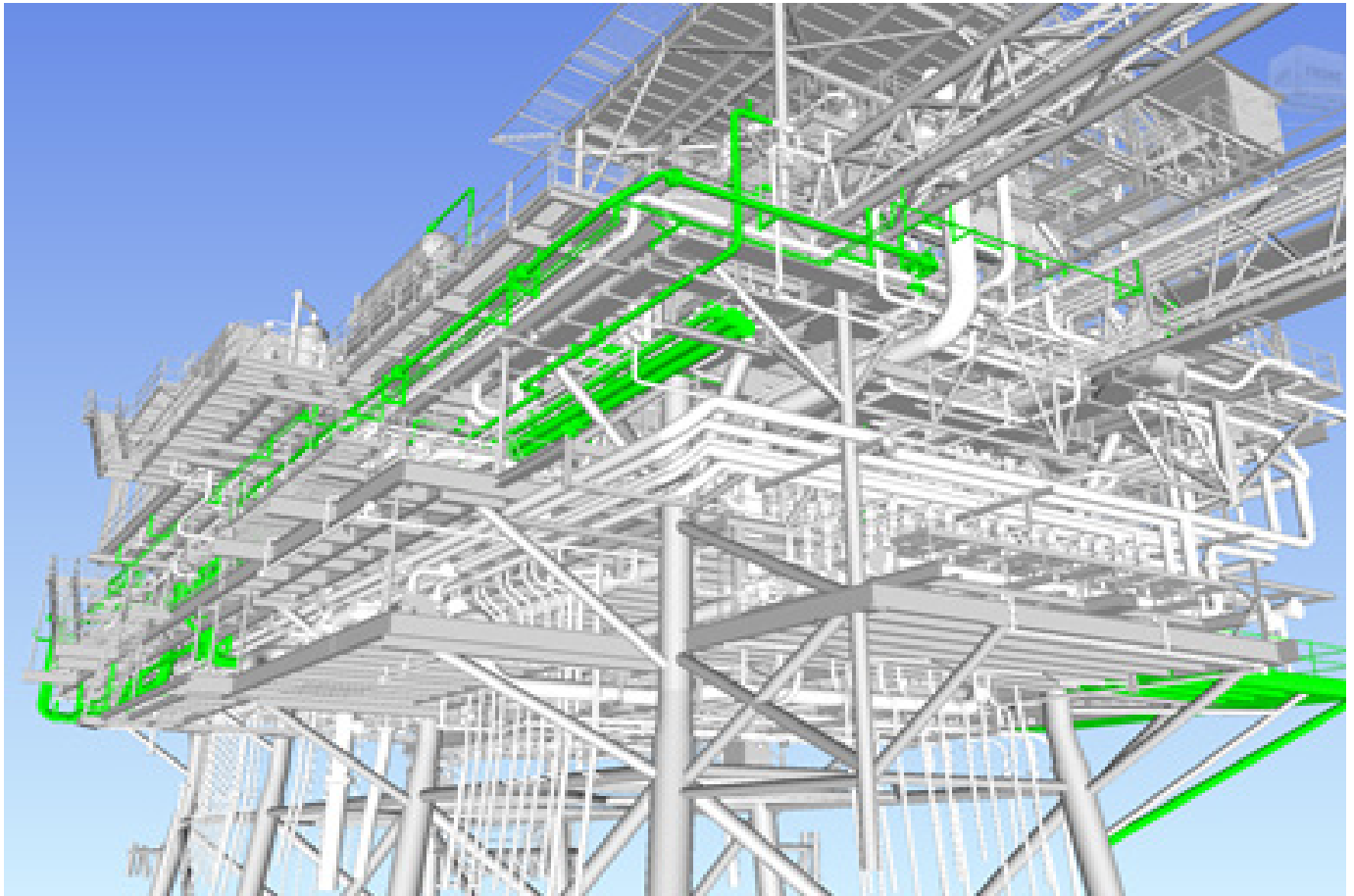

Heavy Cost Impact

The problems needed to be resolved quickly to avoid the serious impact of increased costs, schedule delays and lost production, as well as safety and reliability concerns.

The direct costs alone were heavy. Modification work during installation offshore can take at least twice as long as modifications in the fabrication yard.

Solution

Ariosh started by laser scanning all seven platforms and then 3D modelling the new design. These 3D models were superimposed on the laser data and clash checked using her SureFIT™ Work process. Design verification should obviously be performed prior to fabrication. However, on this project, fabrication of the spools and structures had progressed to over 70% before Ariosh's involvement. These spools and structures were then Laser scanned in the fabrication yard to allow Ariosh to conduct virtual installations of the as-fabricated spools and make recommendations to enable shop correction of installation issues and eliminate offshore rework.

This approach resulted in 98% first-time fit, a substantial reduction in overall installation time and provided the CNL with a significant cost saving.

