

Anchor Handling Tug Vessel (AHT)

Oshe 3 AHT 72T BP DP1



Registration

Owner	Hosh 3 Ltd.
Operator	Hosh 2 Ltd.
Type	Anchor Handling Tug (AHT)
Flag State	Nigeria
Class Society	ABS Class
Classification	A1 Towing Vessel + AMS + AH + FiFi-1, DPS-1

Main Characteristics

Length Overall	46 m
Length Between Perpendicular	39.54 m
Breadth Mld	12.6 m
Depth Mld to Main Deck	5.3 m
Min Draft	4.3 m
Summer Draft	4.5 m
Air Draft	19 m
Gross Tonnage	1072 T

Capacities

Deadweight	509 T
Cargo Deck Area	163 m ²
Cargo Deck Dimensions	18.4 x 8.85 m
Cargo Deck Loading	5.0 mt/m ²
Fuel Oil Cargo	569.5 m ³
Bulk Mud	288.8 m ³
Fresh Drill Water	178.7 m ³
Water Ballast	44.6 m ³
Dirty Oil Tank	15.2 m ³
Lub. Oil Tank	3.8 m ³

Dynamic Positioning System

Class Definition	DP1
Type	Kongsberg Maritime AS
DGPS	2 Units Kongsberg

Propulsion - Machinery

Total Output	2 x 1920 kw Geared Drive
Main Engines	2 Units Caterpillar 35 Kc (Capacity: 2,575BHP)
Propeller	2 x 1920 kw Geared Drive
Drive Type Shaft/ Diesel-Electric	Shaft Diesel

Performance

Full Speed	12 knots
Economic	8 knots

Cargo Discharge

Fuel Oil	1 x 22.06m ³ /hr 486.92 MT head @100%
Cargo Fresh Water	1 x 50m ³ /hr
Drill Water	81 x 50m ³ /hr
Dirty Oil Pump	1 x 9.34m ³ /hr
Bilge/Ballast	1 x 50m ³ /hr
Bulk Material (BM)	74 LT/h at 250 ft (75 mt/h at 60 m)

Deck Equipment

Rescue Boat	1 x (Capacity: 6 Persons) With Inboard Engine
Tugger Winch	2
Deck Cargo Crane	4KN Max Hoist 30KN
Windlass	1
Searchlights	2 x Monkey Island FWD & AFT
Shark Jaws	KAEM FORK 102mm with SWL 300T
Towing Pins	Bollard Pulls 100Tons
Stern Roller Dimension	200T

FiFi/Dispersant System

Type	2 x Fire Fighting System Water Monitor (Capacity: water/foam: 1200/300m ³ /h) 1 x FE 1 x Tetra fire detection alarm system 1 x TYCO CO ₂ System
Dispersant System	2 Center Throw Nozzle
Dispersant Capacity Tank	9m ³
Fire Pumps Capacity	1 x 50 m ³ /hr



Electronics

1 - NavtexFuruno NX 700B
1 - EPIRB McMurdo ES Satellite
2 - McMurdo S4 SART
2 - VHF Furuno FM-8900S
2 - UHF Motorola
1 - X-band Radar (ARPA) Furuno FAR-21179
1 - S Band Radar (ARPA) Furuno 1945
1 - Autopilot
1 - GPS Furuno GP150
1 - Echosounder Furuno FE-700
1 - Inmarsat C
1 - Electronic Fuel Monitoring System (Fueltrax)

Accommodations

Total No. of Bunks	20 Persons
1 Man Cabins	4 Cabins
2 Man Cabins	4 Cabins
4 Man Cabins	2 Cabins
Hospital Room	1
Galley	1

Generators

Bow Thrusters	1 x CPP Bow Thruster (approx. 45 KN)
Auxiliary Generators Make	Cummins
Auxiliary Generators Capacity	3 x 300KWe ISSMXTA 11
Emergency Generator Make	Cummins
Emergency Generator Capacity	1 x CSMXT5.9, 112KWe

Anchor Handling Tug Vessel (AHT)

Oshe 3 AHT 72T BP DP1

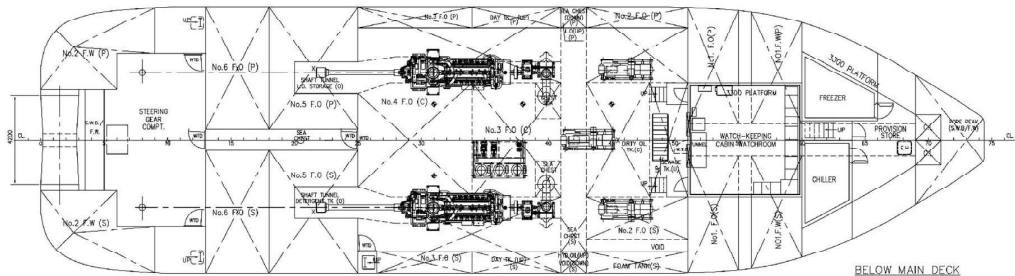
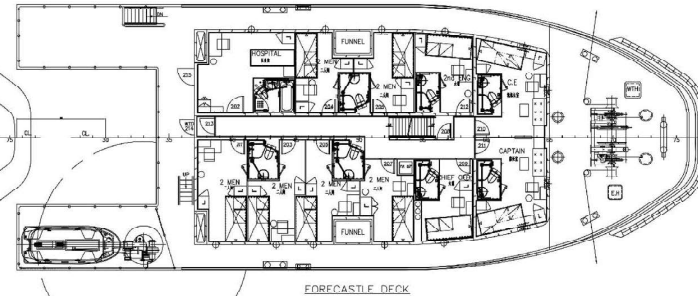
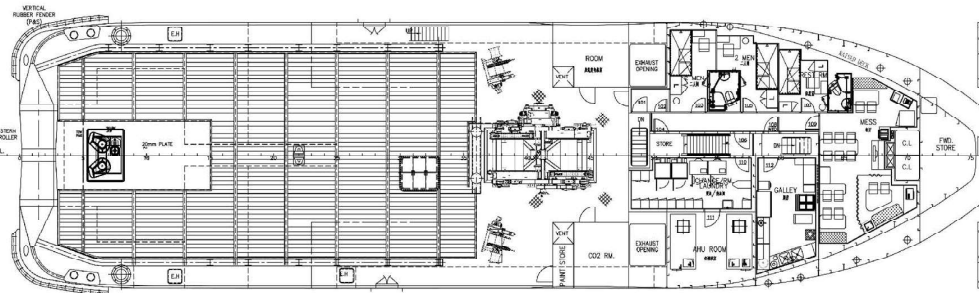
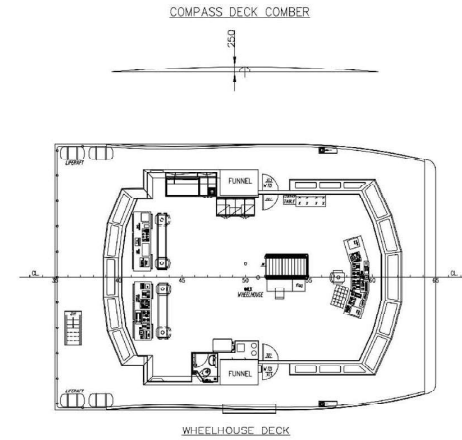
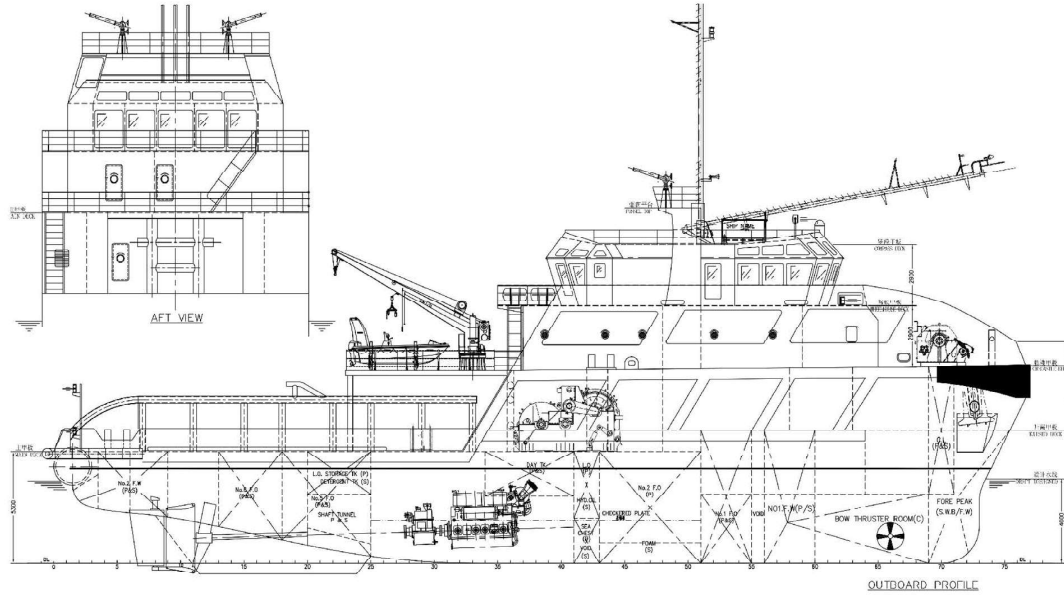

PRINCIPAL PARTICULARS

LENGTH O.A.	46.00m
LENGTH W.L.	44.10m
BEAM MLD.	12.60m
DEPTH M.I.D.	5.30m
DRAFT DESIGNED/MAX.	4.00m/4.5m
COMPLEMENT	20 MEN